



# **CHINESE 100/100G**

## **Beginning Modern Chinese 1**

**Semester 1**  
**2018**

# Contents

|  |    |
|--|----|
| Course description .....                     | 3  |
| Learning schedule .....                      | 4  |
| Assessment.....                              | 5  |
| Marking rubrics.....                         | 8  |
| Teachers: contact and office hour .....      | 9  |
| Mandarin Learning Assistant .....            | 10 |
| Learning recourses (recommended).....        | 11 |
| Standardised Proficiency Test: HSK .....     | 15 |
| Major, Diploma, Certificate and Module.....  | 16 |
| Students' responsibilities .....             | 18 |
| Appendix Characters (CHINESE 100/100G) ..... | 19 |

Find us on Facebook for more information about Chinese language learning



<https://www.facebook.com/uoachinese/>

# Course description

## About the course

This course is designed to provide basic written and spoken skills in Modern Standard Chinese (*Mandarin, Putonghua, Guoyu, Hanyu, Huayu*) and is designed for students who have no previous knowledge of the language or whose study of Chinese is very limited, normally not higher than NCEA 1. This course gradually and systematically introduces characters and grammar points with four-days-a-week tutorials to ensure the best learning results. This course covers Chapter 1- 8 of two textbooks with one focusing on spoken Chinese and the other one on written Chinese. By the end of the course, students are expected to communicate orally in Chinese on simple topics of everyday life, to read simple texts written in Chinese characters and to write about 150 Chinese characters.

**Point value:** 15 points

**Class contact hours:** 1 hour class per day, 4 classes a week

**Total class contact hours:** 48 hours

**Textbooks for 2018:** *Fundamental Spoken Chinese* (FSC); *Fundamental Written Chinese* (FWC)

**Chinese 100 and 100G:** The two courses are taught concurrently. The differences are

- **CHINESE 100G:** If you are studying this course as part of your General Education requirements.
- **CHINESE 100:** If you wish to study Chinese and progress into further study of the language, or you wish to count this course as an elective option.

## Learning Objective (HSK 1)

Learners can understand basic language materials related to common personal and daily life. They can retell, recite and copy words or sentences with fair accuracy and can write words or sentences following the example. They will begin to develop interest and confidence in learning the Chinese language. They will acquire preliminary knowledge of learning strategies, communicative strategies, resource strategies and interdisciplinary strategies under the teacher's guidance. They will gain introductory Chinese cultural knowledge and acquire preliminary cross-cultural competence and international perspectives.

# Learning schedule

| Week                          | Date     | Day | Content                | Note                  | %   |
|-------------------------------|----------|-----|------------------------|-----------------------|-----|
| 1                             | 26 Feb   | Mon | Chapter 1 (1) FSC      |                       |     |
|                               | 27 Feb   | Tue | Chapter 1 (2) FSC      |                       |     |
|                               | 28 Feb   | Wed | Chapter 1 (3) FSC      |                       |     |
|                               | 1 March  | Thu | Chapter 1 (4) FSC      |                       |     |
| 2                             | 5 March  | Mon | Chapter 2 (1) FSC      |                       |     |
|                               | 6 March  | Tue | Chapter 2 (2) FSC      |                       |     |
|                               | 7 March  | Wed | Chapter 2 (3) FSC      |                       |     |
|                               | 8 March  | Thu | Chapter 2 (4) FSC      |                       |     |
| 3                             | 12 March | Mon | Chapter 3 (1) FSC      | Short Test 1 (Ch3)    | 2%  |
|                               | 13 March | Tue | Chapter 3 (2) FSC      |                       |     |
|                               | 14 March | Wed | Chapter 3 (3) FSC      |                       |     |
|                               | 15 March | Thu | Chapter 3 (4) FSC      | Homework due (Ch3)    |     |
| 4                             | 19 March | Mon | Chapter 4 (1) FSC      | Short Test 2 (Ch4)    | 2%  |
|                               | 20 March | Tue | Chapter 4 (2) FSC      |                       |     |
|                               | 21 March | Wed | Chapter 4 (3) FSC, FWC |                       |     |
|                               | 22 March | Thu | Chapter 4 (4) FSC, FWC | Homework due (Ch4)    |     |
| 5                             | 26 March | Mon | Chapter 5 (1) FSC      |                       |     |
|                               | 27 March | Tue | Chapter 5 (2) FSC      |                       |     |
|                               | 28 March | Wed | Chapter 5 (3) FSC, FWC |                       |     |
|                               | 29 March | Thu | Chapter 5 (4) FSC, FWC | Homework due (Ch5)    |     |
| 2-14 April Mid-semester break |          |     |                        |                       |     |
| 6                             | 16 April | Mon | Semester Test          | Evening test/No class | 10% |
|                               | 17 April | Tue | Oral Test 1            | Test in classroom     | 15% |
|                               | 18 April | Wed | Revision               |                       |     |
|                               | 19 April | Thu | Revision               |                       |     |
| 7                             | 23 April | Mon | Chapter 6 (1) FSC      | Short Test 3 (Ch6)    | 2%  |
|                               | 24 April | Tue | Chapter 6 (2) FSC      |                       |     |
|                               | 25 April | Wed | ANZAC Day              | Holiday!              |     |
|                               | 26 April | Thu | Chapter 6 (3) FSC      |                       |     |
| 8                             | 30 April | Mon | Chapter 6 (4) FSC      |                       |     |
|                               | 1 May    | Tue | Chapter 6 (5) FSC, FWC |                       |     |
|                               | 2 May    | Wed | Chapter 6 (6) FSC, FWC |                       |     |
|                               | 3 May    | Thu | Chapter 6 (7) FSC, FWC | Homework due (Ch6)    |     |
| 9                             | 7 May    | Mon | Chapter 7 (1) FSC      | Short Test 4 (Ch7)    | 2%  |
|                               | 8 May    | Tue | Chapter 7 (2) FSC      |                       |     |
|                               | 9 May    | Wed | Chapter 7 (3) FSC      |                       |     |
|                               | 10 May   | Thu | Chapter 7 (4) FSC      |                       |     |
| 10                            | 14 May   | Mon | Chapter 7 (5) FSC, FWC |                       |     |
|                               | 15 May   | Tue | Chapter 7 (6) FSC, FWC |                       |     |
|                               | 16 May   | Wed | Chapter 7 (7) FSC, FWC |                       |     |
|                               | 17 May   | Thu | Chapter 7 (8) FSC, FWC | Homework due (Ch7 )   |     |
| 11                            | 21 May   | Mon | Chapter 8 (1) FSC      | Short Test 5 (Ch8)    | 2%  |
|                               | 22 May   | Tue | Chapter 8 (2) FSC      |                       |     |
|                               | 23 May   | Wed | Chapter 8 (3) FSC, FWC |                       |     |
|                               | 24 May   | Thu | Chapter 8 (4) FSC, FWC | Homework due (Ch8)    |     |
| 12                            | 28 May   | Mon | Chapter 8 (5) FSC, FWC |                       |     |
|                               | 29 May   | Tue | Chapter 8 (6) FSC, FWC |                       |     |
|                               | 30 May   | Wed | Oral Test 2            | Test in classroom     | 15% |
|                               | 31 May   | Thu | Revision               |                       |     |

# Assessment

## Participation (10%)

All students are expected to preview before the class, participate actively during the class, and review after the class. Your participation marks will be earned by 1) coming to the classes prepared, 2) being actively involved in in-class activities, and 3) submitting satisfactory homework on time. You will NOT earn any credits by simply showing up in the classroom unprepared. All short tests are arranged on the first day of a week for each new chapter to exam your preparation. Your participation marks might be deducted due to tardiness, and you will NOT receive any credits if you are late for more than 30 minutes. The teachers will decide your participation marks, and their decision is final. All students are required to attend the stream time they enrolled in. Students are not allowed to attend other stream times without approval from the coordinator and the faculty. Students who attend the wrong stream will be asked to leave the classroom.

The course coordinator understands that people get sick sometimes, or are busy for some other personal reasons. Every student gets three “free days” in the semester, your participation marks will not be affected when you miss no more than three days. However, with the fast pace of the course, it would be very difficult to catch up on your own if you missed a class. If you need to miss more than three days, please submit a valid, written excuse to the course coordinator to make sure your participation marks are not affected. The course coordinator will not process your request without any written evidence.

Note: A valid excuse includes 1) sudden injury or illness that requires a visit to a doctor, 2) death in the family, 3) job interview. All of these must be verifiable via WRITTEN EVIDENCE, such as a doctor’s note, an obituary, a letter from the prospective employer, and etc.

## Written Test (20%)

- **Short Test (10% = 2% x 5)**

There are five short tests in the semester. The short tests are designed to help you keep a steady pace in memorising pinyin and characters. You will be asked to write down the characters or pinyin of the given words. You must take your short tests **at the stream time you enrolled in.** Approved stream-hoppers need to take the short test at their approved stream time. **No make-up tests are allowed under any circumstances.** Short tests are typically administered in the beginning of the class. If you miss the tests because you are late, there is no way to make it up. If you have to miss a short test, you must notify the coordinator **in advance with a valid, written excuse** as defined above.

Note: When serious circumstances (e.g. sudden serious illness or a car accident) prevent you from notifying the coordinator in advance, you must notify the coordinator at the earliest possible opportunity. If you or your representative makes no contact within five days of the scheduled test, you will be awarded a zero grade for the test.

- **Semester Test (10%)**

Date: April 16, Monday

Time: 6:30 – 7:30pm

Venue: To be announced in class

The semester test is scheduled on **Monday 16 April.** If you have another test scheduled at the same time, please contact the coordinator before 28 March, or an alternative test will not be guaranteed. Aside from test

clashes, no other excuses will be considered. Under extreme circumstances, you will have to apply for aegrotat and compassionate consideration. (Please see the link: <https://www.auckland.ac.nz/en/for/current-students/cs-academic-information/cs-examination-information/cs-aegrotat-and-compassionate-consideration.html>)

### Oral Test (30%)

- Oral Test 1 (15%)
- Oral Test 2 (15%)

There are two oral tests in the semester. Each is worth 10% of your final grade. The oral tests are designed to assess your speaking and listening abilities, which are important components of your language learning. You must take your oral tests **at the stream time you enrolled in. No make-up tests are allowed under any circumstances.** If you miss the oral test, there is no way to make it up. Under extreme circumstances, you will have to apply for aegrotat and compassionate consideration. (Please see the link above)

### Final Exam (40%)

The exam is organised by the exam office. If you have any inquiries regarding the exam administration, please contact the exam office directly. Students who fail to attend 50% of the instructional classes will not be able to pass this course because speaking and listening are important components of this course, and these components need to be fulfilled in class. As a result, students who attend less than 50% of the classes will not be allowed to sit in the final exam. They will receive a DNC for this course.

### Homework (Ungraded)

Homework is highly recommended, as it provides more opportunities for you to reinforce your learning. Also, although it does not constitute a formal part of your coursework marks, regular submission does play a critical factor in determining whether a student sitting at the very cusp of a grade boundary at the end of the semester after all assessment marks have been calculated ends up being bumped up or not.

There are homework exercises due frequently. They will not be marked, but satisfactory submission of the homework will improve your class participation marks. There are two types of homework: character homework and chapter homework. You need print out the homework sheets available from Canvas. Homework that was not written on the homework sheet will not be accepted. When submitting the writing homework, please be sure to write down your ID number, your first name and last name, and your enrolled stream time. All homework must be submitted in person on the due day at your stream time. The teachers will collect the homework in the beginning of class. The teachers will NOT accept the homework during class, after class, or outside your stream time. Late homework will NOT be accepted at all.

- Character homework are exercises for you to practice writing characters, and they are due the day after you learn the characters in class. The character exercises are designed to keep you on a steady pace of practicing characters. You need to know the characters before you can move on to reading texts and writing sentences. You cannot wait until the night before the test to learn your characters.
- Chapter homework are writing exercises that consist of exercises mostly from the textbooks FSC and FWC, and they are typically due the last day of the chapter. You are expected to finish them before you come to class. During class, you can correct/polish your answers. In order to improve your proficiency, you need to try to do the exercises yourself instead of copying the answers down.

|                      |               | Percentage | Due day         |
|----------------------|---------------|------------|-----------------|
| <b>Participation</b> |               | 10%        | May 31          |
| <b>Written Test</b>  | Semester Test | 10%        | April 16        |
|                      | Short Test 1  | 2%         | March 12        |
|                      | Short Test 2  | 2%         | March 19        |
|                      | Short Test 3  | 2%         | April 23        |
|                      | Short Test 4  | 2%         | May 7           |
|                      | Short Test 5  | 2%         | May 21          |
| <b>Oral Test</b>     | Oral Test 1   | 15%        | April 17        |
|                      | Oral Test 2   | 15%        | May 30          |
| <b>Final Exam</b>    |               | 40%        | To be confirmed |

# Marking rubrics

## Oral Test

|  | 1 | 2 | 3 | 4 | 5 |
|--|---|---|---|---|---|
| Pronunciation & Fluency  |   |   |   |   |   |
| Use of language (Grammar structure, Vocabulary)                              |   |   |   |   |   |
| Contents of the presentation (The main ideas, structure of the presentation) |   |   |   |   |   |
| TOTAL (15%)  |   |   |   |   |   |

## Workload and deadlines for submission of coursework

The University of Auckland's expectation is that students spend 10 hours per week on a 15-point course, including time in class and personal study. Students should manage their academic workload and other commitments accordingly. Deadlines for coursework are set by course convenors and will be advertised in course material. You should submit your work on time. In extreme circumstances, such as illness, you may seek an extension but you may be required to provide supporting information before the assignment is due. Late assignments without a pre-approved extension may be penalised by loss of marks – check course information for details.

## Important notes

All assessments are held during lecture hours unless otherwise stated. No make-ups are available. In genuinely exceptional circumstances well supported with documentation, students may apply for a compassionate pass by following the procedures set out in the University's examination regulations.

# Teachers: contact and office hour

| Time  | Lecture | Mon        | Tue        | Wed        | Thu        |
|-------|---------|------------|------------|------------|------------|
| 10 am | Lo2C    | Dani Wang  | Hazel Shao | Isaac lu   | Harry Zhao |
| 11 am |         |            |            |            |            |
| 11 am | Lo3C    | Dani Wang  | Hazel Shao | Isaac lu   | Harry Zhao |
| 12 am |         |            |            |            |            |
| 12 pm | Lo4C    | Dani Wang  | Hazel Shao | Isaac lu   | Harry Zhao |
| 1 pm  |         |            |            |            |            |
| 1 pm  | Lo5C    | Hazel Shao | Dani Wang  | Harry      | Isaac lu   |
| 2 pm  |         |            |            |            |            |
| 2 pm  | Lo6C    | Hazel Shao | Dani Wang  | Harry      | Isaac lu   |
| 3 pm  |         |            |            |            |            |
| 3 pm  | Office  | Dani Wang  | Hazel Shao | Isaac lu   | Harry Zhao |
| 4 pm  | Hour    |            |            |            |            |
| 4 pm  | Lo7C    | Hazel Shao | Dani Wang  | Harry Zhao | Isaac lu   |
| 5 pm  |         |            |            |            |            |

**Coordinator:** Danping Wang (Dani)  
**Office address:** Rm 422, 18 Symonds Street, Arts 2 (207-422)  
**Phone number:** 373-7599- ext. 86918  
**Office hour:** Monday 2-4pm or by appointment (2 hours)  
**Email:** danping.wang@auckland.ac.nz

**Teacher:** Juechen Shao (Hazel)  
**Office address:** Rm 313C, 18 Symonds Street, Arts 2 (207-313C)  
**Office hour:** Tuesday 3-4pm or by appointment (1 hour)  
**Email:** Jshag10@aucklanduni.ac.nz

**Teacher:** Wai Fung lu (Isaac)  
**Office address:** Rm 313C, 18 Symonds Street, Arts 2 (207-313C)  
**Office hour:** Wednesday 3-4pm or by appointment (1 hour)  
**Email:** Wiu026@aucklanduni.ac.nz

**Teacher:** Pengfei Zhao (Harry)  
**Office address:** Rm 313C, 18 Symonds Street, Arts 2 (207-313C)  
**Office hour:** Thursday 3-4pm or by appointment (1 hour)  
**Email:** p.zhao@aucklanduni.ac.nz

# Mandarin Learning Assistant

We are very happy to have a Mandarin Learning Assistant to help students learn and practice Chinese on campus. You are encouraged to make appointments at any office hour of the week with Judy Chen to get her help with your pronunciation, assignments, Chinese characters, and get ready for your tests and exams. During her Friday office hour, we will provide a 3 hour on-site language learning support specifically to all CHINESE 100/G students.

|                        |   |
|------------------------|---|
| <b>Assistant:</b>      | <b>Shumin Chen (Judy)</b>   |
| <b>Office address:</b> | <b>Rm 420, 18 Symonds Street, Arts 2 (207-420)</b><br><b>Feel free to drop by at any time</b> |
| <b>Office hour:</b>    | <b>Friday 9am – 12 noon (3 hours)</b><br><b>Rm 313C, 18 Symonds Street, Arts 2 (207-313C)</b> |
| <b>Email:</b>          | <b>sche454@aucklanduni.ac.nz</b>  |

With the help of our MLA, we will organise a few cultural activities to help you learn and understand the Chinese language and culture in this semester. Your teachers will let you know the details about our learning opportunities soon. Please also feel free to let your teachers know what you would like us to do in order to help you get together to form an enjoyable Chinese learning community.

# Learning recourses (recommended)

## 1. Mobile applications

### Hello Chinese



It has a nice pronunciation section in the beginning, making this slightly better to use as your first app. The main course is free. It offers an optional premium paid subscription in addition to the free learning experience which grants you access to interesting games.



### Memrise



The Memrise app offers numerous lists that you can include in your study program, such as: the complete list of radicals, all of the HSK vocabulary lists, etc. It helps you remember words by using visual or conceptual mnemonic rules that are created and tested by the developers and the enormous community of students.

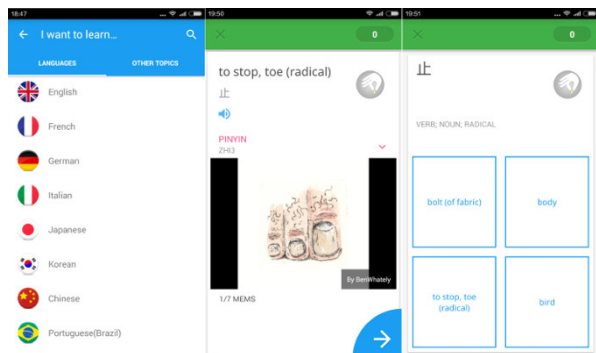

### Skritter Chinese



Tons of textbooks, characters and words available; study offline, auto-sync when you reconnect; handwriting recognition with instant feedback; advanced study algorithm designed just for Chinese.



## 2. Webpages and channels

Yoyo Chinese

Videos on pinyin, characters for beginners.



<https://www.youtube.com/user/sloppycheng>

A Bite of China

Well-made Chinese documentary television series on the history of food, eating, and cooking in China.



<https://www.youtube.com/watch?v=4jopH3nBZYw>

Ychina  
歪果仁研究协会

Ychina brings you to the forefront of Chinese culture, media and technology while answering the question: Why China?



<https://www.youtube.com/channel/UCvVlk8oQ2vnZsCi4vRgO4dg>

## Chairman's Bao

You can have a look of the Blogs on the website, which focused on introducing Learning Mandarin Chinese and Chinese Culture. Also, you can have look of those sample articles which can help you on learning Chinese vocabularies and grammar. More importantly, those sample articles are free.

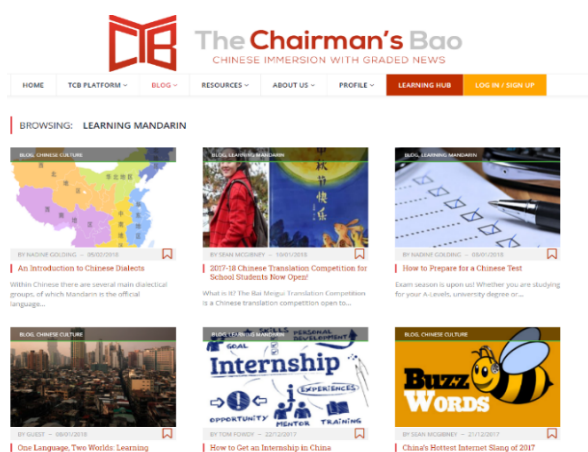

<https://www.thechairmansbao.com/>

## Chinese class101

Suitable for beginners, lots of Chinese-learning materials such can be found. It is recommended to watch the Chinese-learning Videos on the page which can help you to get a better understanding of Chinese language as well as Chinese Culture.



<https://www.facebook.com/ChineseClass101/www.chinese101.com>

## Learn Chinese

You can find tons of Chinese-learning videos or news-clips on the page, and the contents of those videos or news-clips are more daily-life-oriented.



<https://www.facebook.com/crilearnchinese/>

### 3. Books, flashcards and dictionaries

#### Chinese for Dummies

Curious about Chinese? Whether you're a student, a traveller, doing international business, or you just want to pick up basic Chinese, this clear, easy-to-follow guide will have you pronouncing words in standard Mandarin like a native speaker. From grammar, numbers, and vocabulary to greetings, popular expressions, and proper etiquette, you'll make yourself understood in no time!

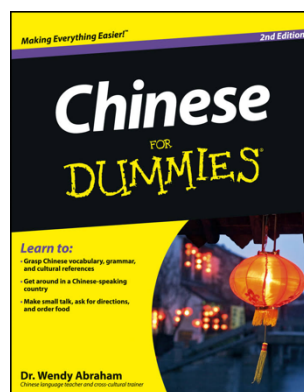

#### Mandarin Vocabulary

This 6-page guide provides grammar points / vocabulary essentials for students, travellers and businesspeople. Divided into tables that show the Mandarin character (ideogram), the pinyin (Mandarin transliterated into the Latin alphabet) and the English translation for every vocabulary word/phrase covered, this guide is both comprehensive and user-friendly.



#### Chinese Character Dictionary

Learn the characters you need to know: over 3,000 of the most frequently used Chinese characters used in everyday Chinese communication. Advance your knowledge: over 32,000 common words and expressions from the HSK proficiency test.



# Standardised Proficiency Test: HSK

# HSK

Chinese Proficiency Test

## 汉语水平考试

HSK (Hanyu Shuiping Kaoshi) or the Chinese Proficiency Test is an international standardized exam which tests and rates Chinese language proficiency. It evaluates Chinese language abilities for non-native Chinese speakers in term of using the Chinese language in their daily, academic and professional lives. The HSK Certificate offers a reference for Chinese language learners to understand and improve their ability to apply Chinese, and for employers to hire, train and promote employees.

HSK test consists of a writing test and a speaking test, which are independent of each other. There are six levels of writing tests, namely the HSK (level I), HSK (level II), HSK (level III), HSK (level IV), HSK (level V), and HSK (level VI). There are three levels of speaking tests, namely the HSK Speaking Test (beginner level), HSK Speaking Test (intermediate level), and HSK Speaking Test (advanced level). During the speaking test, test takers' speeches will be recorded.

### **HSK (Level I) [150 Chinese characters, 150 New words]**

Test takers can understand and use very simple Chinese phrases, meet basic needs for communication and possess the ability to further their Chinese language studies.

### **HSK (Level II) [300 Chinese characters, 300 New words]**

Test takers have an excellent grasp of basic Chinese and can communicate in simple and routine tasks requiring a simple and direct exchange of information on familiar and routine matters.

### **HSK (Level III) [600 Chinese characters, 600 New words]**

Test takers can communicate in Chinese at a basic level in their daily, academic and professional lives. They can manage most communication in Chinese when travelling in China.

### **HSK (Level IV) [1,000 Chinese characters, 1,200 New words]**

Test takers can converse in Chinese on a wide range of topics and are able to communicate fluently with native Chinese speakers.

### **HSK (Level V) [1,500 Chinese characters, 2,500 New words]**

Test takers can read Chinese newspapers and magazines, enjoy Chinese films and plays, and give a full-length speech in Chinese.

### **HSK (Level VI) [2,500 Chinese characters, 5,000 New words]**

Test takers can easily comprehend written and spoken information in Chinese and can effectively express themselves in Chinese, both orally and on paper.

# Major, Diploma, Certificate and Module

After one semester of learning with us, I am sure you will find learning Chinese is engaging, fun and useful. If you want to continue learning the language to achieve another milestone and become more proficient in Chinese. There are a few options for you to consider.

## Major in Chinese

**Compulsory courses:** ASIAN100; CHINESE130; CHINESE301

**Total points:** 120 points including at least 45 points above stage 2, including

30 points from stage 2 subject courses (for 2018): CHINESE203; ASIAN200; HISTORY213; HISTORY222

15 points from stage 3 subject courses (for 2018): CHINESE303; ASIAN303; HISTORY322; POLITICS354

## Diploma in languages

Two semesters, 120 points in one or two languages with at least 60 points above stage 1, including at least 30 points above stage 2, alongside BA or any other degree.

## Certificate in languages

One semester, 60 points in one or two languages with at least 30 points above stage 1. Part-time language study alongside BA or any other degree.

## Module (as an optional part of BA)

**Modern Language: Chinese 1**

45 points from CHINESE 100, 101, 177, 178, 200, 201, 277, 278 (Must include 15 points from above stage 1)

**Modern Language: Chinese 2**

45 points from CHINESE 200, 201, 300, 301, 302, 377, 378 (Must include 15 points from above stage 2)

## Minor (Only for students enrolled before 2018)

Minor must include CHINESE 130 and 15 points from CHINESE 201 or 302

A minor at least 90 points, of which at least 60 points must be above stage 1

## 2018 CHINESE PROGRAMME

| LANGUAGE  |  | CULTURE   |   |
|-----------|--|---|---|
|           | CORE COURSES   | STUDY ABROAD  |   |
| Stage I   | CHINESE100 (S1)<br>Beginning Modern Chinese 1<br><br>CHINESE101 (S2)<br>Beginning Modern Chinese 2             | <br><br><br><br><br>(Prerequisite: 101)<br>CHINESE178 (SS)                    | <b>ASIAN100 (S1)</b><br><b>Images of Asia</b><br><br><b>CHINESE130 (S2)</b><br><b>Rethinking China</b>  |
| Stage II  | CHINESE200 (S1)<br>Intermediate Modern Chinese 1<br><br>CHINESE201 (S2)<br>Intermediate Modern Chinese 2       | <br><br><br><br><br>(Prerequisite: 201)<br>CHINESE277 (SS)<br>CHINESE278 (SS) | <b>30 points from:</b><br><br>CHINESE203 (S2)<br>China on Screen<br><br>ASIAN200 (S1)<br>Asian Identities<br><br>HISTORY222 (S2)<br>Late Imperial China   |
| Stage III | CHINESE300 (S1)<br>Advanced Modern Chinese 1<br><br><b>CHINESE301 (S2)</b><br><b>Advanced Modern Chinese 2</b> | <br><br><br><br><br>(Prerequisite: 301)<br>CHINESE377 (SS)<br>CHINESE378 (SS) | <b>15 points from:</b><br><br>CHINESE303 (S1)<br>China on Screen<br><br>ASIAN303 (S2)<br>Asian Identities<br><br>HISTORY322(S2)<br>Late Imperial China<br><br>POLITICS354 (S2)<br>China and the World |

\*S1=Semester One, S2 = Semester Two, SS = Summer Semester

\*\* Courses are subject to change. Please check course website for the availability.

# Students' responsibilities

## Language Ability Declaration (LAD)

This course is designed for complete beginners who have no previous knowledge of Mandarin, or students who have limited knowledge of Chinese and was placed in this course after the screening process. If you already speak some Mandarin or other Chinese dialects/languages, and/or have received previous education in written Chinese, please see the course coordinator immediately unless you were interviewed. Per conditions of your Language Ability Declaration, if we subsequently discover that you have not been completely forthcoming with us with regard to your language ability and/or previous exposure to written and/or spoken Chinese, the University may cancel your enrolment in language courses at any time in the semester, regardless of how late in the semester it may happen to be. Misrepresentation of prior study is considered academic misconduct, and it may result in having a record in the University Register of Academic Misconduct, or being referred to the Discipline Committee. Failure to complete the Language Ability Declaration will result in deletion of the enrolment.

## Class representatives

The course reps usually run a Facebook page for social interaction among students who use Facebook. We strongly encourage you to join the course group on Facebook to share useful information about the course or interesting Chinese learning materials with each other. Teachers may provide online learning materials and exciting information about Chinese cultural activities through Facebook as well.

However, you need to be aware that the University of Auckland Information and Communications Technology (ICT) Statute sets out rules governing use of any ICT hardware or software at or for University activities. It forbids using ICT "to store, display or communicate... files containing any text, image that is deceptive or misleading, is abusive or defamatory, contravenes anyone's privacy... or that reproduces all or part of any work in breach of the Copyright Act 1994". The Statute refers students to the relevant University Disciplinary Statute and the penalties that may apply. It can be found at: <https://policies.auckland.ac.nz/student-undergraduate.aspx>

## Staff-Student Consultative Committee meeting (SSCC)

Students' voice is valued for making the course more effective and successful. Your comments and suggestions are welcome at the SSCC meeting.

## Email policy

Important (and sometimes urgent) announcement will be send through Canvas announcement. It is your responsibility to read the announcement carefully and check it regularly. Canvas allows you set your preference on notification (under Account > Notifications), make sure you have the right setting so you won't receive important announcement a week later.

The course coordinator and all the teaching staff are happy to answer your emails. It is customary to address an email to the recipient and to end it with your own name. Not to do so comes across as rudeness. The teaching staff reserve the rights to not to answer any rude emails.

## Appendix Characters (CHINESE 100/100G)

| Chapter | Radicals | Characters | Pinyin | No of Strokes |
|---------|----------|------------|--------|---------------|
| 4       | 八        | 八          | bā     | 2             |
| 4       | 木        | 本          | běn    | 5             |
| 4       | 一        | 不          | bù     | 4             |
| 4       | 大        | 大          | dà     | 3             |
| 4       | 一        | 二          | èr     | 2             |
| 4       | 见        | 见          | jiàn   | 4             |
| 4       | 丿        | 九          | jiǔ    | 2             |
| 4       | 一        | 七          | qī     | 2             |
| 4       | 人        | 人          | rén    | 2             |
| 4       | 日        | 日          | rì     | 4             |
| 4       | 一        | 三          | sān    | 3             |
| 4       | 十        | 十          | shí    | 2             |
| 4       | 乙        | 书          | shū    | 4             |
| 4       | 口        | 四          | sì     | 5             |
| 4       | 王        | 王          | wáng   | 4             |
| 4       | 文        | 文          | wén    | 4             |
| 4       | 戈        | 我          | wǒ     | 7             |
| 4       | 一        | 五          | wǔ     | 4             |
| 4       | 西        | 西          | xī     | 6             |
| 4       | 小        | 小          | xiǎo   | 3             |
| 4       | 乙        | 也          | yě     | 3             |
| 4       | 一        | 一          | yī     | 1             |
| 4       | 一        | 再          | zài    | 6             |
| 4       | 丨        | 中          | zhōng  | 4             |
| 5       | 一        | 百          | bǎi    | 6             |
| 5       | 讠        | 词          | cí     | 7             |
| 5       | 儿        | 儿          | ér     | 2             |
| 5       | 人        | 个          | gè     | 3             |
| 5       | 讠        | 话          | huà    | 8             |
| 5       | 人        | 会          | huì    | 6             |

|   |   |   |           |    |
|---|---|---|-----------|----|
| 5 | 几 | 几 | jǐ        | 2  |
| 5 | 口 | 可 | kě        | 5  |
| 5 | 一 | 两 | liǎng     | 7  |
| 5 | 口 | 吗 | ma        | 6  |
| 5 | 毛 | 毛 | máo       | 4  |
| 5 | 厶 | 么 | me        | 3  |
| 5 | 亻 | 们 | men       | 4  |
| 5 | 口 | 呢 | ne        | 8  |
| 5 | 亻 | 你 | nǐ        | 7  |
| 5 | 女 | 女 | nǚ        | 3  |
| 5 | 十 | 千 | qiān      | 3  |
| 5 | 亻 | 什 | shén      | 4  |
| 5 | 丩 | 生 | shēng     | 5  |
| 5 | 讠 | 说 | shuō      | 9  |
| 5 | 亻 | 他 | tā        | 5  |
| 5 | 大 | 太 | tài       | 4  |
| 5 | 口 | 问 | wèn       | 6  |
| 5 | 儿 | 先 | xiān      | 6  |
| 5 | 人 | 以 | yǐ        | 4  |
| 5 | 讠 | 语 | yǔ        | 9  |
| 5 | 十 | 真 | zhēn      | 10 |
| 5 | 口 | 只 | zhǐ       | 5  |
| 5 | 十 | 支 | zhī       | 4  |
| 5 | 子 | 子 | zǐ        | 3  |
| 6 | 口 | 哎 | āi        | 8  |
| 6 | 八 | 半 | bàn       | 5  |
| 6 | 亻 | 便 | biàn/pián | 9  |
| 6 | 车 | 车 | chē       | 4  |
| 6 | 彳 | 得 | děi/de    | 11 |
| 6 | 八 | 弟 | dì        | 7  |
| 6 | 日 | 电 | diàn      | 5  |
| 6 | 八 | 典 | diǎn      | 7  |
| 6 | 亻 | 份 | fèn       | 6  |
| 6 | 八 | 分 | fēn       | 4  |

|   |   |   |           |    |
|---|---|---|-----------|----|
| 6 | 父 | 父 | fù        | 4  |
| 6 | 口 | 告 | gào       | 6  |
| 6 | 口 | 哥 | gē        | 10 |
| 6 | 八 | 共 | gòng      | 6  |
| 6 | 女 | 好 | hǎo       | 6  |
| 6 | 彳 | 很 | hěn       | 9  |
| 6 | 凵 | 画 | huà       | 8  |
| 6 | 宀 | 家 | jiā       | 10 |
| 6 | 女 | 姐 | jiě       | 8  |
| 6 | 口 | 口 | kǒu       | 3  |
| 6 | 八 | 兰 | lán       | 5  |
| 6 | 女 | 妈 | mā        | 6  |
| 6 | 乙 | 买 | mǎi       | 6  |
| 6 | 女 | 妹 | mèi       | 8  |
| 6 | 母 | 母 | mǔ        | 5  |
| 6 | 讠 | 诉 | sù        | 7  |
| 6 | 女 | 她 | tā        | 5  |
| 6 | 一 | 万 | wàn       | 3  |
| 6 | 女 | 姓 | xìng      | 8  |
| 6 | 彳 | 行 | xíng/háng | 6  |
| 6 | 口 | 兄 | xiōng     | 5  |
| 6 | 口 | 呀 | ya        | 7  |
| 6 | 女 | 要 | yào       | 9  |
| 6 | 宀 | 宜 | yí        | 8  |
| 6 | 宀 | 字 | zì        | 6  |
| 6 | 自 | 自 | zì        | 6  |
| 7 | 心 | 必 | bì        | 5  |
| 7 | 冫 | 冰 | bīng      | 6  |
| 7 | 亻 | 伯 | bó        | 7  |
| 7 | 口 | 吃 | chī       | 6  |
| 7 | 辶 | 道 | dào       | 12 |
| 7 | 一 | 东 | dōng      | 6  |
| 7 | 饣 | 饿 | è         | 10 |
| 7 | 饣 | 饭 | fàn       | 7  |

|   |   |   |          |    |
|---|---|---|----------|----|
| 7 | 口 | 啡 | fēi      | 11 |
| 7 | 讠 | 馆 | guǎn     | 11 |
| 7 | 八 | 关 | guān     | 6  |
| 7 | 辶 | 还 | hái/huán | 7  |
| 7 | 讠 | 汉 | hàn      | 5  |
| 7 | 口 | 喝 | hē       | 12 |
| 7 | 讠 | 酒 | jiǔ      | 10 |
| 7 | 口 | 咖 | kā       | 8  |
| 7 | 宀 | 客 | kè       | 9  |
| 7 | 忄 | 快 | kuài     | 7  |
| 7 | 丩 | 乐 | lè       | 5  |
| 7 | 乙 | 了 | le/liǎo  | 2  |
| 7 | 十 | 卖 | mài      | 8  |
| 7 | 忄 | 忙 | máng     | 6  |
| 7 | 讠 | 没 | méi      | 7  |
| 7 | 气 | 气 | qì       | 4  |
| 7 | 八 | 前 | qián     | 9  |
| 7 | 讠 | 请 | qǐng     | 10 |
| 7 | 水 | 水 | shuǐ     | 4  |
| 7 | 辶 | 送 | sòng     | 9  |
| 7 | 丩 | 午 | wǔ       | 4  |
| 7 | 心 | 想 | xiǎng    | 13 |
| 7 | 心 | 意 | yì       | 13 |
| 7 | 口 | 知 | zhī      | 8  |
| 7 | 亻 | 做 | zuò      | 11 |
| 8 | 口 | 吧 | ba       | 7  |
| 8 | 白 | 白 | bái      | 5  |
| 8 | 饣 | 饱 | bǎo      | 8  |
| 8 | 竹 | 笨 | bèn      | 11 |
| 8 | 竹 | 笔 | bǐ       | 10 |
| 8 | 土 | 地 | de/dì    | 5  |
| 8 | 阝 | 都 | dōu      | 10 |
| 8 | 又 | 对 | duì      | 5  |
| 8 | 讠 | 法 | fǎ       | 8  |

|   |   |   |        |    |
|---|---|---|--------|----|
| 8 | 口 | 国 | guó    | 7  |
| 8 | 又 | 欢 | huān   | 6  |
| 8 | 口 | 叫 | jiào   | 5  |
| 8 | 日 | 旧 | jiù    | 5  |
| 8 | 土 | 块 | kuài   | 6  |
| 8 | 口 | 名 | míng   | 6  |
| 8 | 日 | 明 | míng   | 8  |
| 8 | β | 那 | nà     | 6  |
| 8 | 女 | 奶 | nǎi    | 5  |
| 8 | 牛 | 牛 | niú    | 4  |
| 8 | 月 | 朋 | péng   | 8  |
| 8 | 皮 | 皮 | pí     | 5  |
| 8 | 土 | 去 | qù     | 5  |
| 8 | 宀 | 容 | róng   | 10 |
| 8 | 日 | 是 | shì    | 9  |
| 8 | 又 | 叔 | shū    | 8  |
| 8 | 又 | 双 | shuāng | 4  |
| 8 | 心 | 思 | sī     | 9  |
| 8 | 氵 | 汤 | tāng   | 6  |
| 8 | 口 | 图 | tú     | 8  |
| 8 | 日 | 晚 | wǎn    | 12 |
| 8 | 又 | 友 | yǒu    | 5  |
| 8 | 月 | 有 | yǒu    | 6  |
| 8 | 土 | 在 | zài    | 6  |
| 8 | 日 | 早 | zǎo    | 6  |
| 8 | 辶 | 这 | zhè    | 7  |